

TARRAT KILVET  
MAALIT JA LIIMAT

DEKALER SKYLTA  
FÄRGER OCH LIM

STICKERS SIGN  
PLATES PAINTS AND  
GLUE

AUFKLEBER SCHILD  
FARBE UND  
KLEBSTOFF

AUTOCOLLANTS,  
PLAQUES  
D'INDICATION,  
PEINTURES ET  
COLLE

11-41

1.6.2007

T121c, T121h, T131c, T131h,  
T151eh, T151eLS, T161c, T161h,  
T161LS, T171c, T171h, T171LS,  
T191h, T191LS

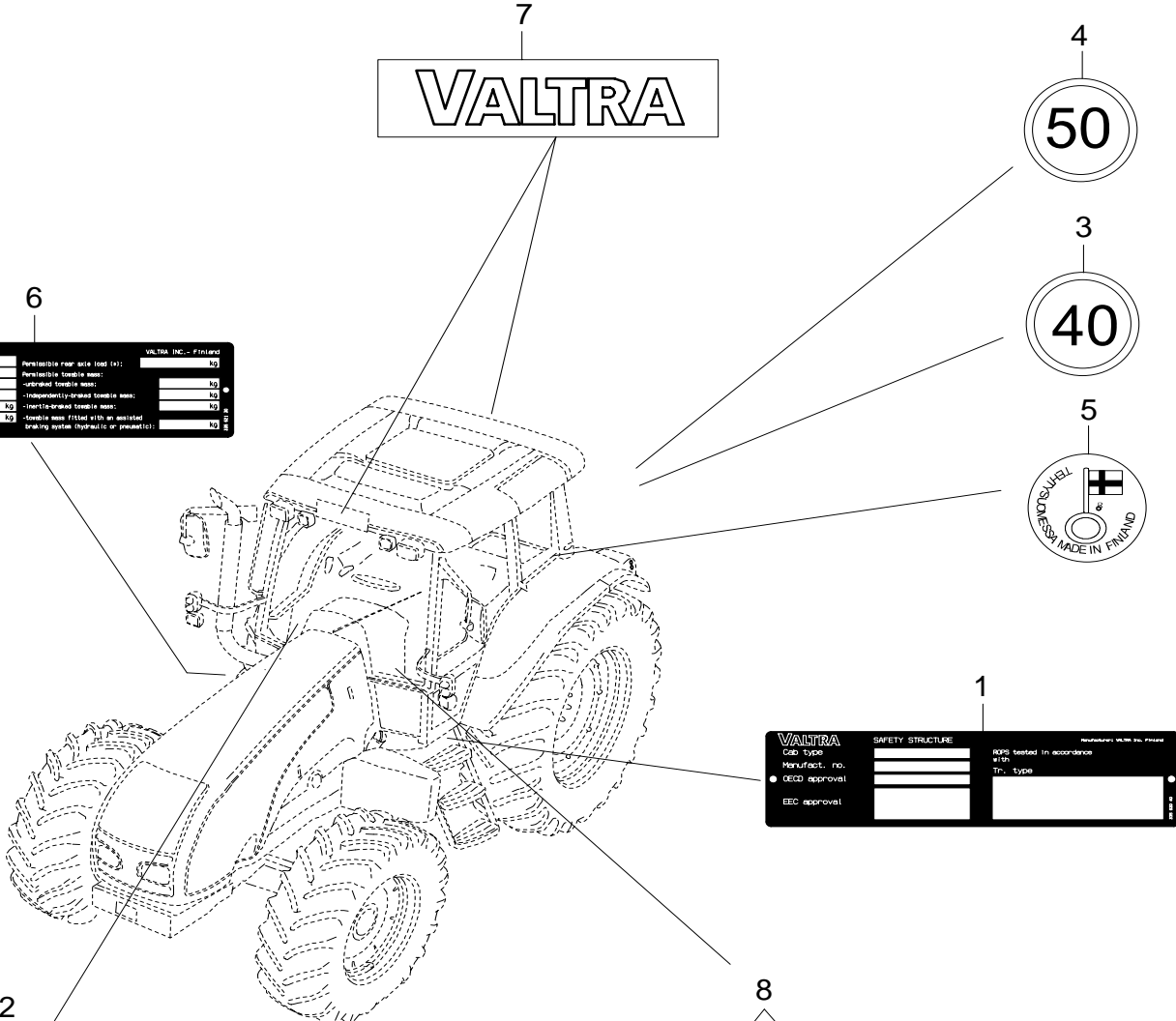

| VALTRA                           |    | VALTRA INC. - Finland   |    |
|----------------------------------|----|---|----|
| Type:                            |    | Permissible rear axle load (x):   | kg |
| Mod:                             |    | Permissible towable mass:   | kg |
| EC model:                        |    | Permissible towable mass:   | kg |
| Identification number:           |    | Permissible towable mass:   | kg |
| Total permissible mass (x):      | kg | Permissible towable mass:   | kg |
| Permissible front axle load (x): | kg | Towable mass (1) and/or limited breaking action (hydraulic or pneumatic): | kg |

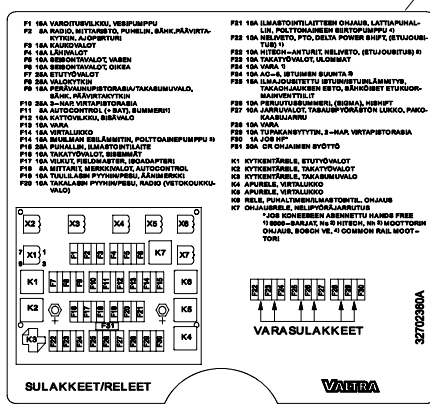
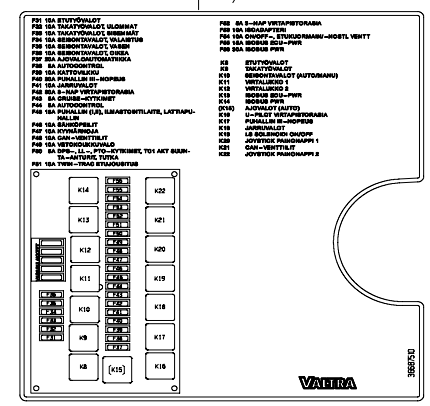

1

| VALTRA        |  | SAFETY STRUCTURE               |  |
|---------------|--|--------------------------------|--|
| Cap. type     |  | APD tested in accordance with: |  |
| Manufact. no. |  | Tn. type                       |  |
| CEC approval  |  |                                |  |
| EEC approval  |  |                                |  |

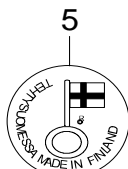
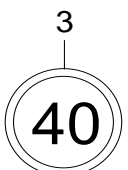
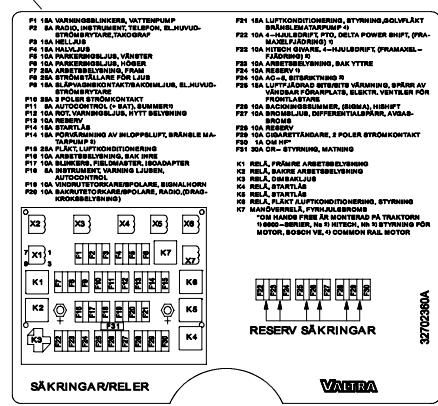

VALTRA 3270380A

VALTRA 3270380A

VALTRA 3270380A

TARRANT JA KILVET

DEKALER OCH  
SKYLTVAR

STICKERS AND SIGN  
PLATES

AUFKLEBER UND  
SCHILD

AUTOCOLLANTS ET  
PLAQUES  
D'INDICATION

11-43

1.6.2007

T121c, T121h, T131c, T131h,  
T151eh, T151eLS, T161c, T161h,  
T161LS, T171c, T171h, T171LS,  
T191h, T191LS

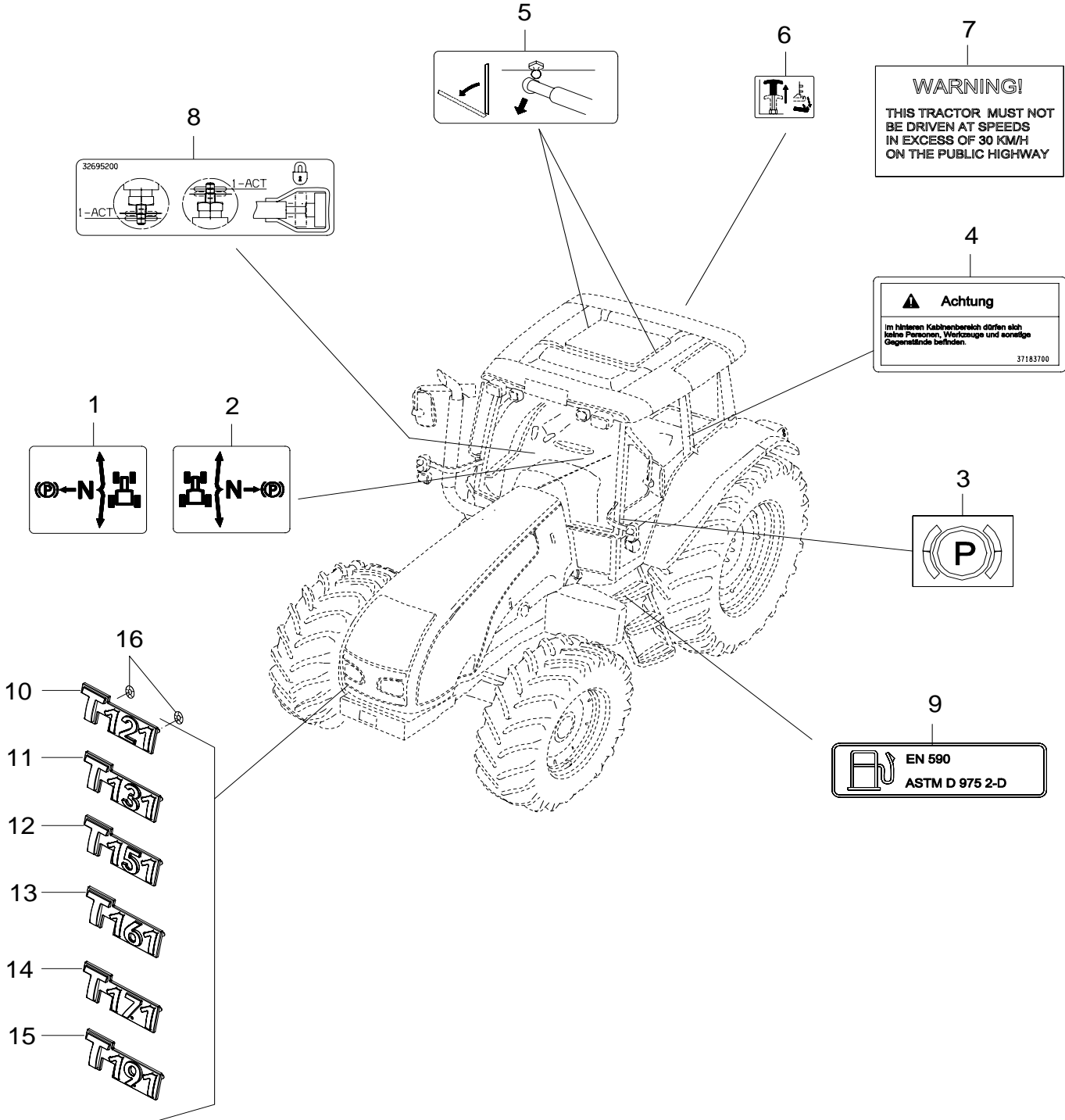



Linssin asennus  
Lens adjustment

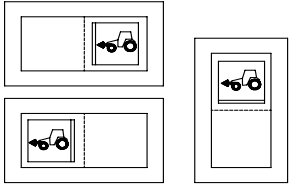

|    |  |    |              |     |              |    |                   |    |            |    |  |
|----|--|----|--------------|-----|--------------|----|-------------------|----|------------|----|--|
| 1  |  | 18 |              | 36  | CONTROL STOP | 52 |                   | 71 | FL         | 88 |  |
| 2  |  | 19 |              | 37  | CONTROL STOP | 53 |                   | 72 |            | 89 |  |
| 3  |  | 20 |              | 38  |              | 54 |                   | 73 |            | 90 |  |
| 4  |  | 21 |              | 39  |              | 55 |                   | 74 |            | 91 |  |
| 5  |  | 22 |              | 40  |              | 56 |                   | 75 |            |    |  |
| 6  |  | 23 |              | 41  | CRUISE       | 57 |                   | 76 |            |    |  |
| 7  |  | 24 |              | 42  | AUTO         | 59 |                   | 77 |            |    |  |
| 8  |  | 25 |              | 42A |              | 60 | AUTO              | 78 |            |    |  |
| 9  |  | 26 | AUTO         | 43  |              | 61 | ISO               | 79 |            |    |  |
| 10 |  | 27 |              | 44  |              | 62 | ISO               | 80 |            |    |  |
| 11 |  | 29 |              | 45  |              | 64 | N AUTO            | 81 |            |    |  |
| 12 |  | 30 | AUTO         | 46  |              | 65 |                   | 82 |            |    |  |
| 13 |  | 31 | 5 MAX. min   | 47  |              | 66 | REC 1 0 UP        | 83 |            |    |  |
| 14 |  | 32 | 5 MAX. min   | 48  | STOP         | 67 | FRONT PUMP OFF/LS | 84 |            |    |  |
| 15 |  | 33 |              | 49  |              | 68 | LS/CP             | 85 |            |    |  |
| 16 |  | 34 |              | 50  |              | 69 | FL/RV             | 86 |            |    |  |
| 17 |  | 35 | AUTO CONTROL | 51  |              | 70 | FL                | 87 | REC 1 0 UP |    |  |

2

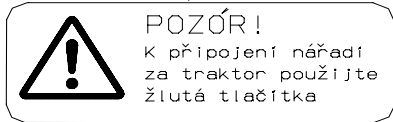

3

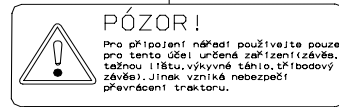

1

4

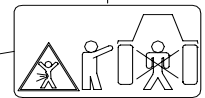

6

5

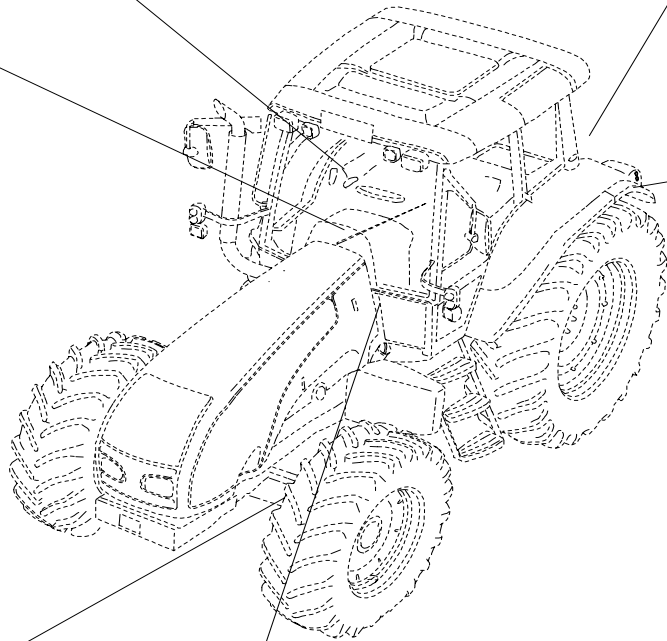
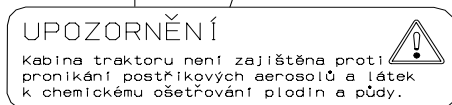

**CAUTION**

**To avoid injury**

- Read the Operator's Instruction Book for safety information and operating instructions.
- Fasten your seat belt before tractor operation.
- Start engine only when seated in operator's seat.
- Make sure everyone is clear of tractor and equipment before starting engine or operation.

- Keep all shields, covers and guards in place and stay away from moving parts while engine is running.
- Place transmission shift lever in neutral and apply parking brake before using external 3-point hitch controls.
- Apply parking brake, lower equipment, stop engine and remove key before leaving the tractor unattended.

- Wait for all movement to stop before servicing tractor or equipment.
- Securely support or block lifted implements which must be in the raised position for servicing or adjustment.
- Couple brake pedals together for road travel.
- Use flashing warning lights and SMV emblem when on public roads, except where prohibited by law.
- Always drive with care and attention.

**WARNING**

Serious personal injury or machine damage may result from overspeed of PTO driven equipment. Do not operate PTO above recommended maximum speed.

| Normal | Maximum at 2400rpm |
|--------|--------------------|
| 540    | 1020               |
| 1000   | 1200               |

For further information refer to operator instruction book.

**WARNING**

**USE SEAT BELT.**

Keep seat belt adjusted snugly.

Do not jump if tractor tips.

**WARNING**

Personal injury may result from PTO driveline separation.

| PTO RPM | SHAFT SIZE      | DISTANCE "A"     |
|---------|-----------------|------------------|
| 540     | 35mm (1.38 in)  | 306mm (13.78 in) |
| 1000    | 35mm (1.38 in)  | 400mm (15.85 in) |
| 1000    | 45 mm (1.75 in) | 500mm (19.69 in) |

THREE-POINT HITCH: distance "C" and mounted implement distance "D" may not be standard.

Measure distance "B" over complete lift range for tractor and implement combination. Select driveline length to ensure that driveline will not bottom out at minimum distance "B" and will have sufficient overlap at maximum distance "B".

**WARNING**

Beware of hot surfaces.

**WARNING**

**NO RIDERS**

**WARNING**

To prevent serious injury or death from loss of control:

- apply parking brake and shut off engine before turning operator's station;
- do not operate on public roads with operator's station reversed; lighting and marking are not compatible with reverse travel;
- keep brake pedals locked together when operating in reverse position.

**DANGER**

Start only from seat with transmission and PTO in neutral.

Starting in gear kills.

**WARNING**

Remove negative cables from batteries before removing solenoid cover and before servicing the electrical system.

**WARNING**

Beware hot parts.

To avoid personal injury, keep all shields, covers and guards in place while engine is running.

**WARNING**

Keep hands clear of fan and belts while engine is running.

**WARNING**

Battery posts, terminals, and related accessories contain lead and lead compounds, chemicals known to the State of California to cause cancer and reproductive harm.

Wash hands after handling.

**WARNING**

High pressure steam and hot water. Remove filler cap with extreme care.

|  |   |  |
|--|---|--|
| <b>DANGER</b>  | <b>DANGER</b>   | <b>WARNING</b>                                       |
|  |   |  |
| Pull only from approved drawbar or lower links of 3-point linkage at horizontal position or below. | Rotating driveline contact may cause serious injury or death. Keep all driveline tractor and equipment shields in place during operation. | Stand clear when using switch to move 3 point hitch. |

**DANGER**

|             |               |                        |                |
|-------------|---------------|------------------------|----------------|
| Shield eyes | Explosive gas | Avoid sparks and flame | Sulphuric acid |
|-------------|---------------|------------------------|----------------|

Always shield eyes and face from battery. Cigarettes, flames or sparks could cause battery to explode. Do not charge or use booster cables or adjust post connections without proper instruction or training.

**POISON causes severe burns**

Contains sulphuric acid. Avoid contact with skin, eyes or clothing. In event of accident flush with water and call a physician immediately. Keep out of reach of children.

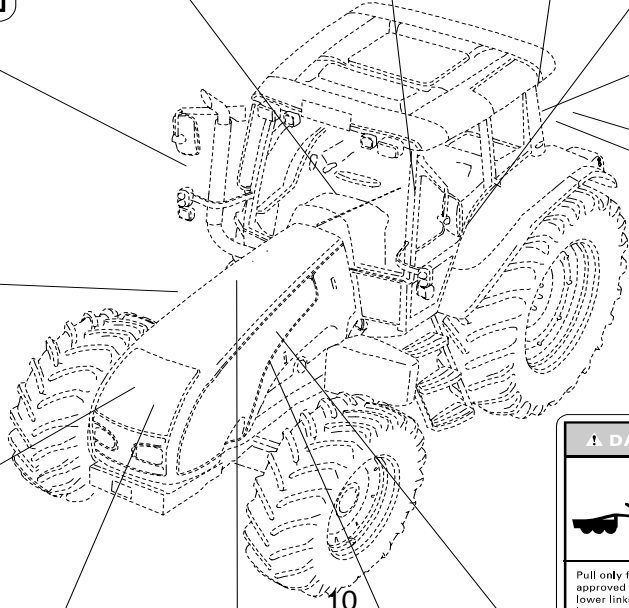

AIRFILTER CAB

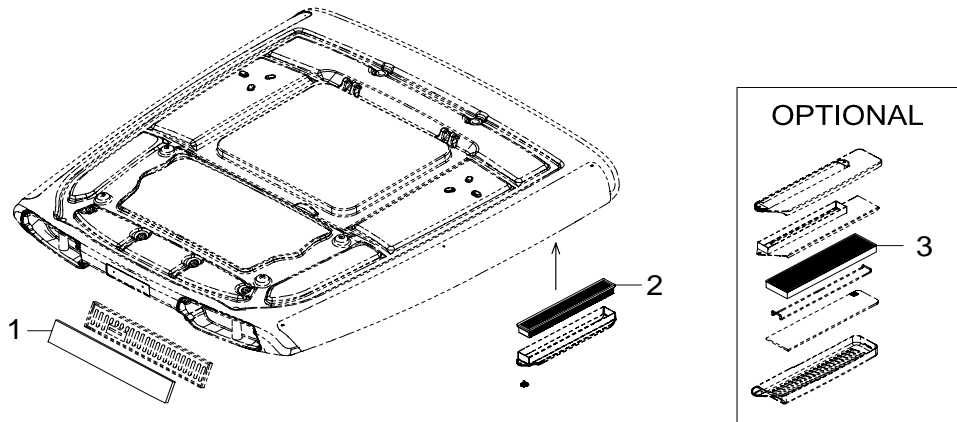

OILFILTER ENGINE

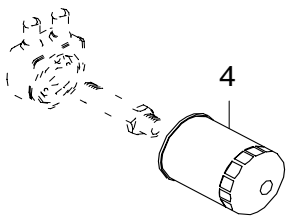

AIRFILTER ENGINE

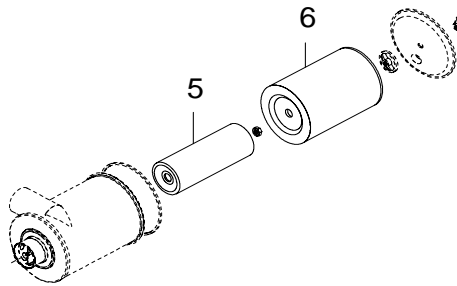

FUEL FILTERS

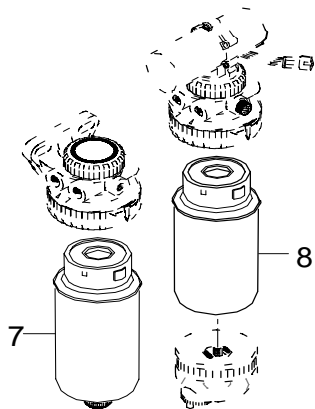

HYDRAULIC AND LOW PRESSURE  
HYDRAULIC FILTERS

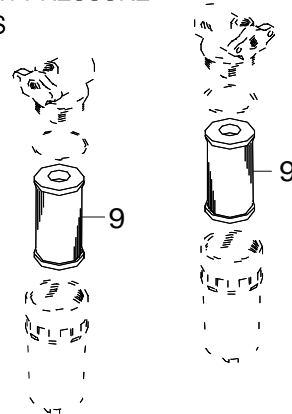

OILFILTER GEARBOX

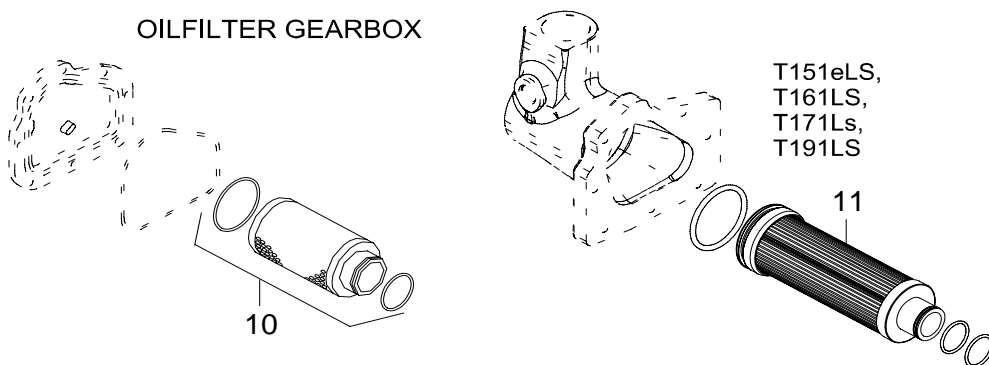

T151eLS,  
 T161LS,  
 T171LS,  
 T191LS

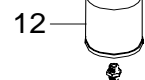

1.6.2007

T121c, T121h, T131c, T131h,  
T151eh, T151eLS, T161c, T161h,  
T161LS, T171c, T171h, T171LS,  
T191h, T191LS

100 h

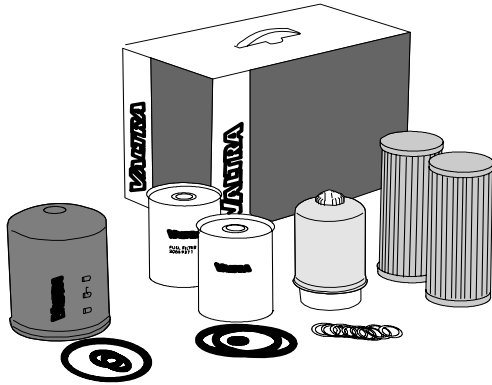

1

500 h

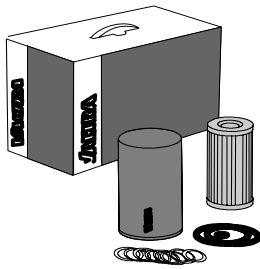

2

1000 h

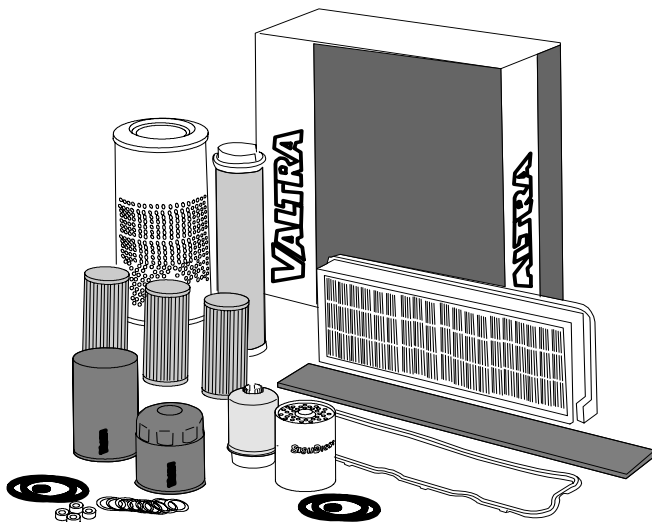

3

4

+ 2000 h

